

RICOH Ri 1000

Shipment Instructions

Flush ink of the printer and fill with cleaning solution

- Remove Ink Cartridges
- Insert Cleaning Cartridges

- Go to  tab

- Select 

- Select 

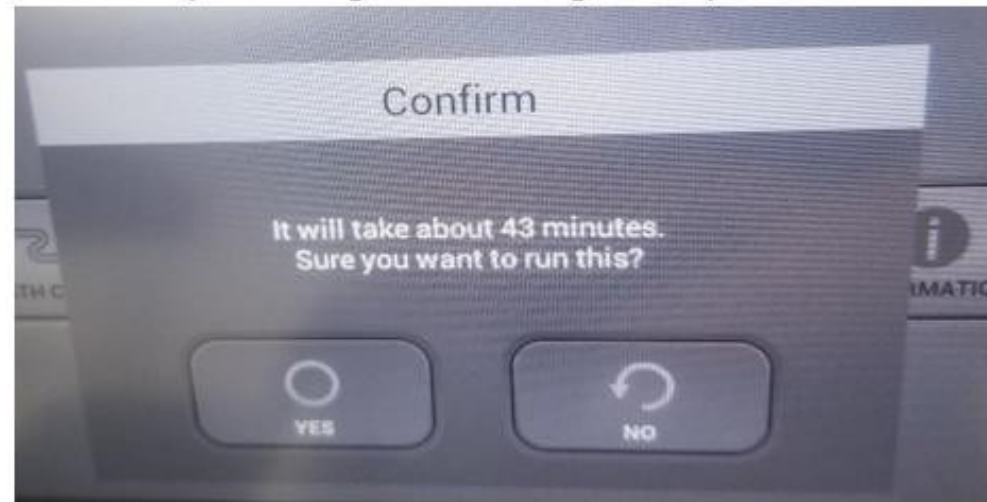

- Confirm by selecting YES to charge the system with cleaning solution

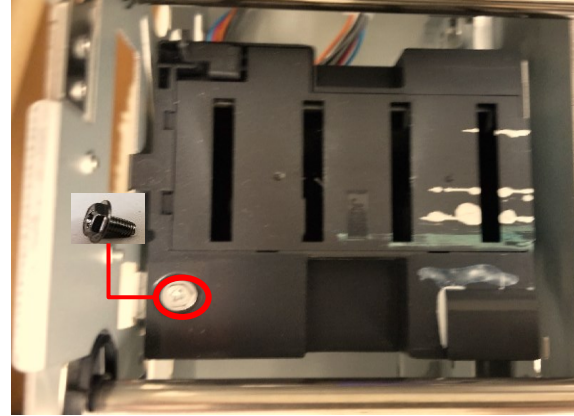

Empty Left Ink Sump

- Remove, rinse, and drain the left ink sump



- Install the left ink sump
- Go to maintenance tab 
- Select [MANUAL HEAD CLEAN] 
- Confirm by selecting [YES] to initiate manual clean



Remove Maintenance Unit and Empty Right Ink Sump

- Turn off the printer and flip the power switch to the off position
- Remove the maintenance unit

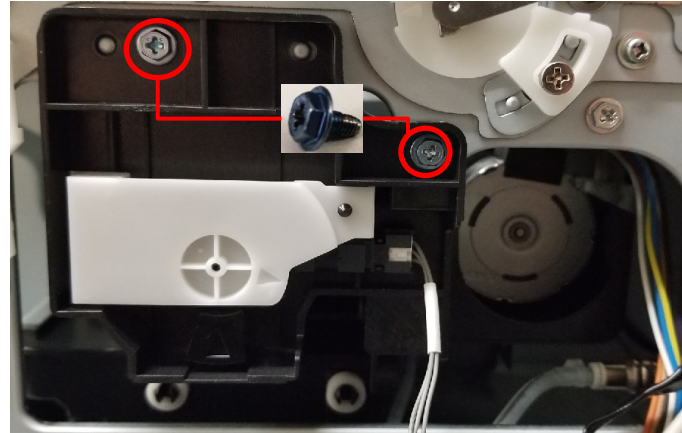

- Remove, rinse, and drain the right ink sump

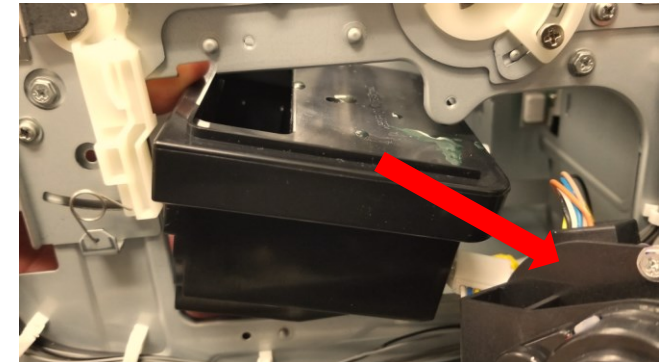
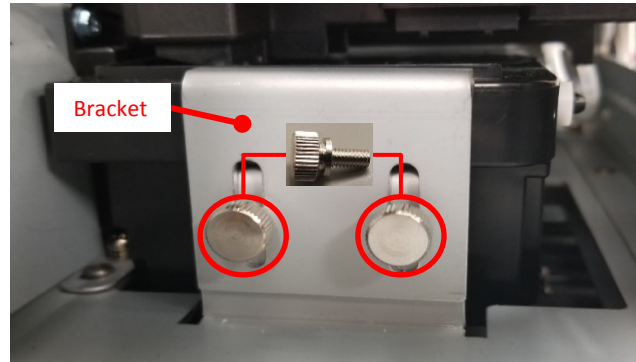

Install Maintenance Unit and Right Ink Sump

- Install the right ink sump

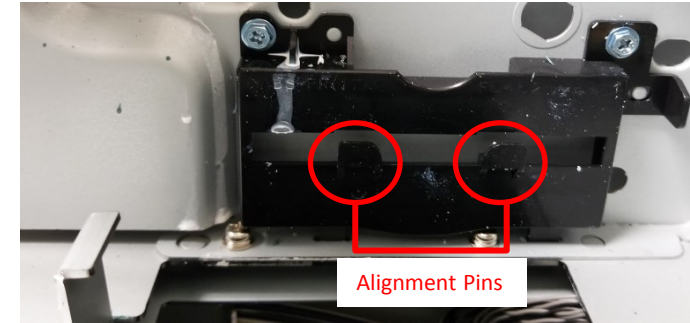

- Install the maintenance unit

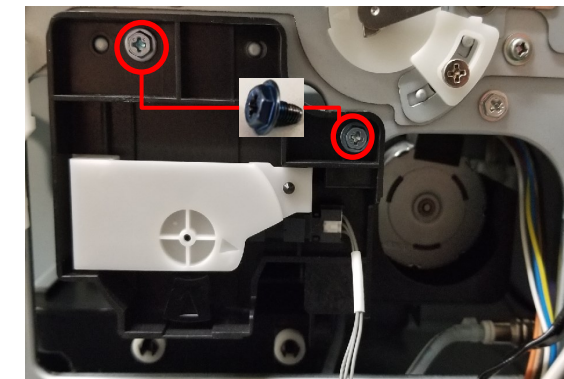
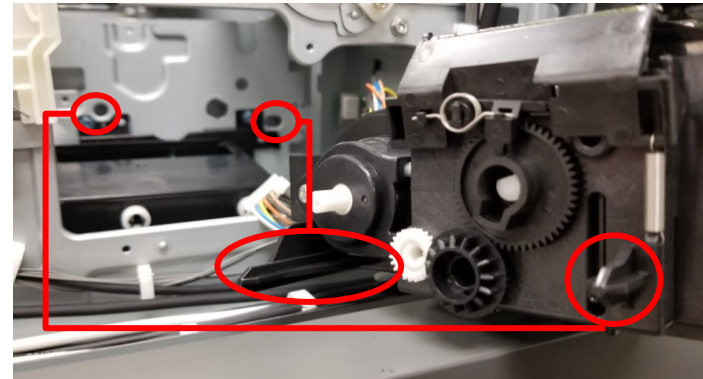

- Turn on the printer to secure the carriage
- Turn off the printer once the printer has finished initializing

Secure Shipping Foam or Bracket

(depending on printer was shipped to you)



Table in printer is secured by Foam block with the platen removed.

Secure shipping bracket with 4 Philips screws

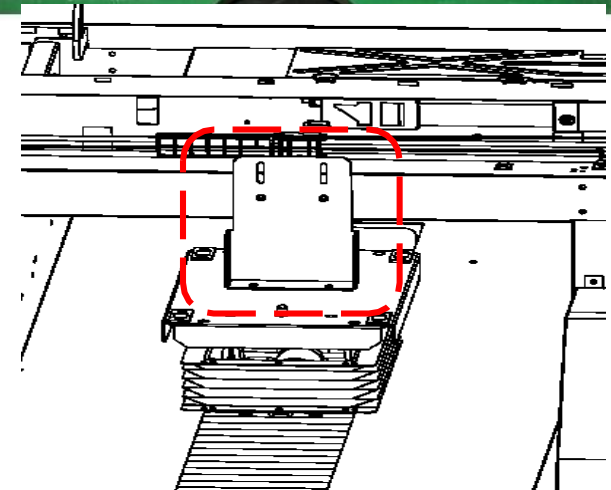

Place Printer in Box: Step 1



Place Printer in Box: Step 2

* Recommended to use 4 people to place printer into box*



Place Printer in
Box: Step 3
* put box frame
on box bottom*



Place Printer in Box: Step 4

* insert brace on either side of table*



Place Printer in Box: Step 5

insert foam brace (mid and front)



Place Printer
in Box: Step 6
* put foam
cover on top
of printer *





Place Printer in
Box: Step 7
Put top on box
